

Nullifire B300 - Pipe Wraps

May 2007 - UK - B300 - APP
Revision 1

Page 1 of 3

1. PRODUCT DESCRIPTION

Nullifire System B300 Pipe Wraps consist of flexible intumescent strips sealed in a protective sleeve with a self-adhesive joining strip.

They are used in conjunction with a sealing material such as B220, B270 or B240 Fire Stop Compound to stop the spread of fire along PVCu pipes where these pass through compartment walls and floors. In a fire the intumescent expands and seals the pipe by crushing it and filling the void.

2. INSTALLATION CHECK LIST

- Ensure the B300 Pipe Wrap is the correct size to fit the pipe diameter.
- Ensure that B220/B240 Fire Stop Compound or similar material is available for back filling around pipes if required.
- Check if single or double wraps are required (depends on wall thickness).
- Ensure access is available around pipes.

3. PRODUCT DIMENSION

External Diameter of Pipe	Product Code	Dimension(mm)		
		Length	Thickness	Width
55mm	B300-55	222	8	50
82mm	B300-82	308	8	100
110mm	B300-110	395	8	100
160mm	B300-160	580	12	100

4. PRODUCT SELECTOR

PRODUCT SELECTOR - 2 HOURS

Product Code	B300-55/2	B300-82/2	B300-110/2	B300-160/2
Outside Diameter of Pipe (mm)	55	82	110	160
Wall Installation Fire Protection	2 hours	2 hours	2 hours	2 hours
Floor Installation Fire Protection	2 hours	2 hours	2 hours	2 hours

PRODUCT SELECTOR- 4 HOURS

Product Code	B300-55/4	B300-82/4	B300-110/4	B300-160/4
Outside Diameter of Pipe (mm)	55	82	110	160
Wall Installation Fire Protection	4 hours	4 hours	4 hours	4 hours
Floor Installation Fire Protection	4 hours	4 hours	4 hours	4 hours

5. INSTALLATION INSTRUCTIONS

The Pipe Wrap is factory sealed in a plastic sleeve to suit your plastic pipe diameter. Please do NOT remove this sleeve.

It is important that the edges of the wraps are within 20mm of the outer faces of the barrier (B220/B270/B240 Compound) or the wall (see Diagram A).

If the thickness of the adjacent structured element is >150mm then 2 No. Wraps should be used (see Diagram B).

In a floor situation the wrap should be positioned flush with slab soffit (see Diagram C).

Nullifire B300 - Pipe Wraps

May 2007 - UK - B300 - APP
Revision 1

Page 2 of 3

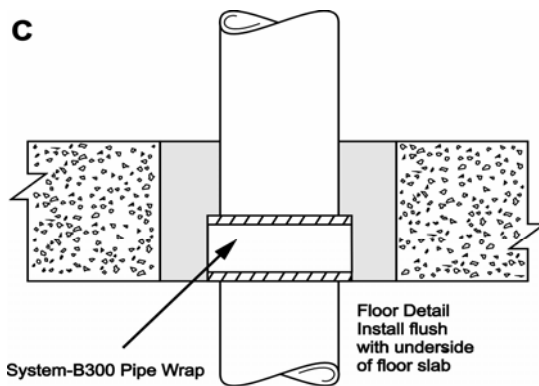
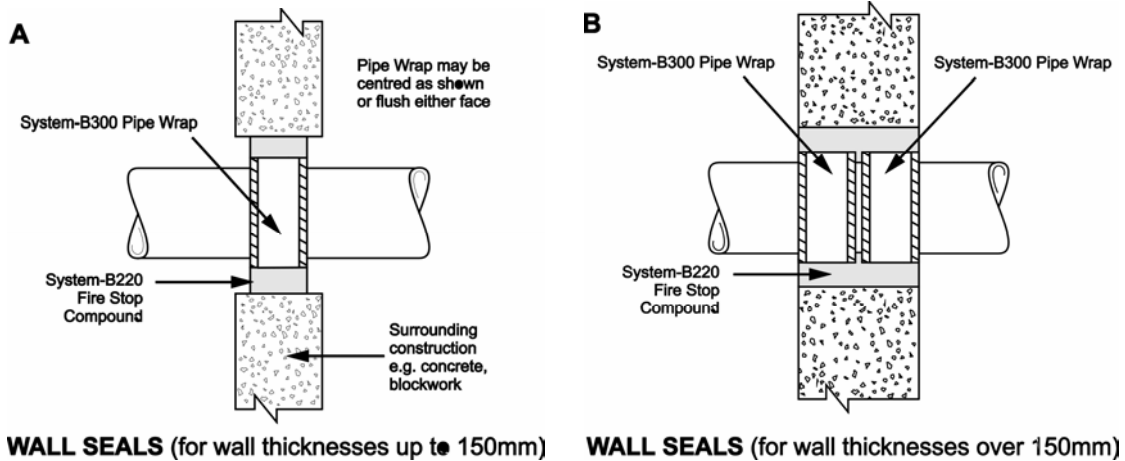

FLOOR SEALS

Ensure the pipe is clean and free of grease. Position the wrap around the circumference of the pipe and remove backing paper from adhesive strip. Press firmly onto the adjoining face of the wrap and slide it into position.

Fill the space between the pipe and the surrounding structure using System B220/B270/B240 Fire Stop Compound or similar material.

6. PARTITIONING

For fire rated partitioning systems refer to B600 Pipe Sleeves.

7. STORAGE

To avoid damage, store under cover in a dry environment between 0°C and 40°C. Keep away from sources of ignition.

Nullifire Limited

Torrington Avenue, Coventry CV4 9TJ, United Kingdom
Telephone + 44 (0)24 7685 5000 Facsimile + 44 (0)24 7646 9547
e-mail protect@nullifire.com website www.nullifire.com



This information is offered in good faith but without guarantee or liability. In cases of doubt, users should consult with relevant authority. Information given herein is supplied for your guidance only and is based upon the results of controlled tests and experience obtained in the application of the product referred to by Nullifire Ltd. As the supplier only, Nullifire Ltd has no control over the method or conditions of application of the product and consequently no warranties expressed or implied are intended to be given as to the coverage or performance of the products mentioned or referred to herein and no liability will be excepted for any loss, damage or physical injury resulting from the use or application of the information, data or products mentioned or referred to herein.

Nullifire B300 - Pipe Wraps

May 2007 - UK - B300 - APP
Revision 1

Page 3 of 3

8. TO ORDER

B300 Pipe Wraps are sold individually in a range of sizes. When ordering state outside pipe diameter and fire rating required.

In the U.K., B300 Pipe Wraps can be ordered directly from Nullifire Ltd, Coventry on +44 (0) 24 7685 5000.

In other countries, B400 Profile Fillers can be purchased through a network of Distributors, details of which can be obtained from Nullifire or from our Web site on <http://www.nullifire.com>.

9. TECHNICAL ASSISTANCE

Further assistance can be obtained by calling the Nullifire Technical Hotline or by e-mail – protect@nullifire.com.

Contract Support is available on request.

Nullifire run a training school in the U.K. for applicators. Full information can be obtained from Nullifire.

10. HEALTH AND SAFETY

A separate Material Safety Data Sheet is available.

Nullifire Limited

Torrington Avenue, Coventry CV4 9TJ, United Kingdom

Telephone + 44 (0)24 7685 5000 **Facsimile** + 44 (0)24 7646 9547

e-mail protact@nullifire.com **website** www.nullifire.com



This information is offered in good faith but without guarantee or liability. In cases of doubt, users should consult with relevant authority. Information given herein is supplied for your guidance only and is based upon the results of controlled tests and experience obtained in the application of the product referred to by Nullifire Ltd. As the supplier only, Nullifire Ltd has no control over the method or conditions of application of the product and consequently no warranties expressed or implied are intended to be given as to the coverage or performance of the products mentioned or referred to herein and no liability will be excepted for any loss, damage or physical injury resulting from the use or application of the information, data or products mentioned or referred to herein.